

GENERAL NOTES

1. ALL WORK SHALL BE COMPLETED BY THE CONTRACTOR AS SHOWN ON THIS PLAN. THE CONTRACTOR SHALL BE RESPONSIBLE FOR OBTAINING ALL NECESSARY PERMITS AND APPROVALS FROM THE APPROPRIATE AGENCIES.
2. THE CONTRACTOR SHALL BE RESPONSIBLE FOR OBTAINING ALL NECESSARY PERMITS AND APPROVALS FROM THE APPROPRIATE AGENCIES.
3. THE CONTRACTOR SHALL BE RESPONSIBLE FOR OBTAINING ALL NECESSARY PERMITS AND APPROVALS FROM THE APPROPRIATE AGENCIES.



JEFFERSON PARISH LAW ENFORCEMENT OFFICE
1000 PINE STREET, SUITE 100
JEFFERSON, LA 70052

DATE	BY

JEFFERSON PARISH LAW ENFORCEMENT OFFICE
1000 PINE STREET, SUITE 100
JEFFERSON, LA 70052

COMPOSITE PLAN PHASE 1

DATE	BY

A101

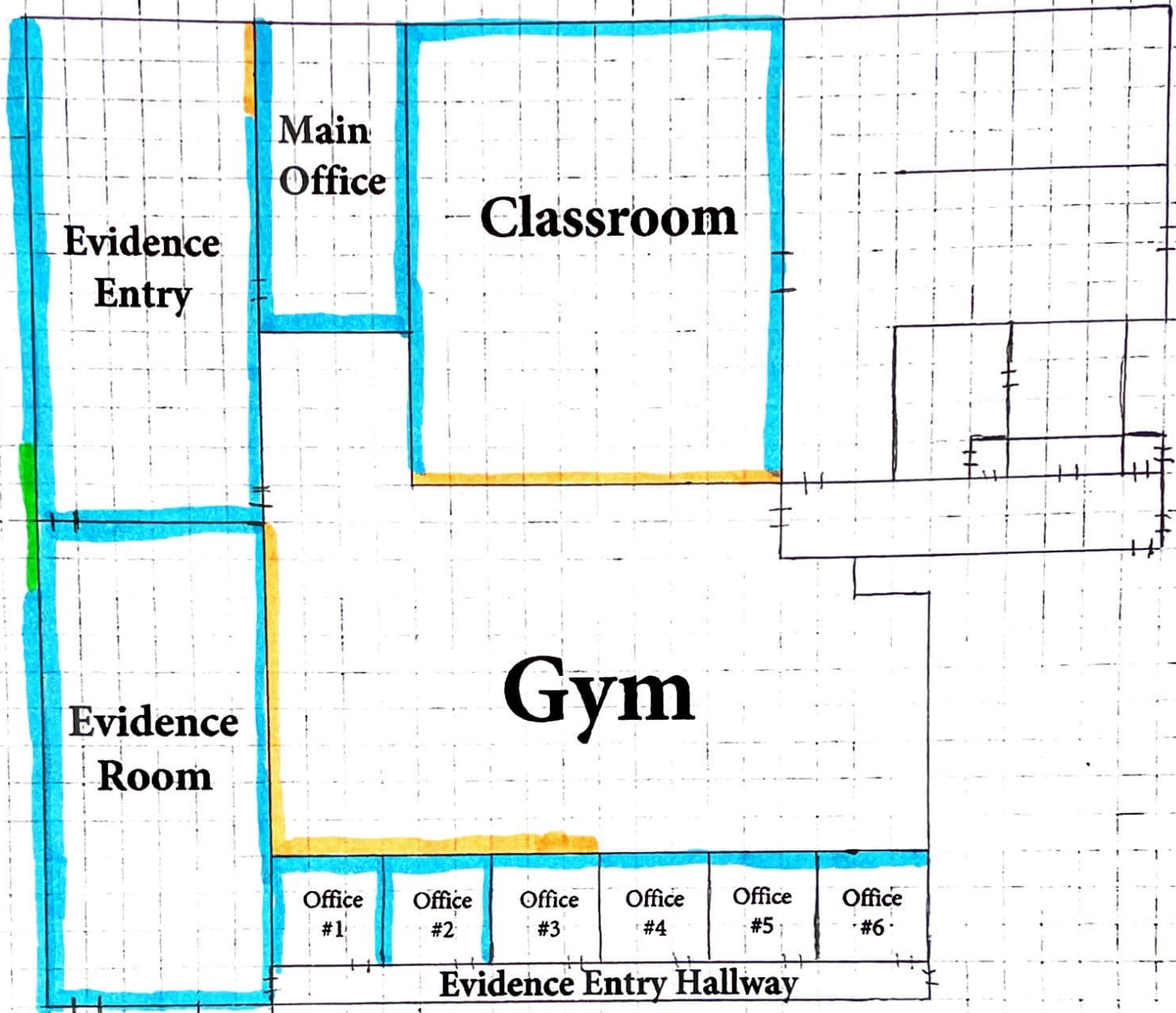

Evidence Warehouse

- 6"
- 2'
- 4'
- 6'
- 8'
- F+to C